

REV	MODIFICATIONS	DRAWN BY	CHECKED BY	DATE
AA	CREATION	MIP	GT	07/03/11

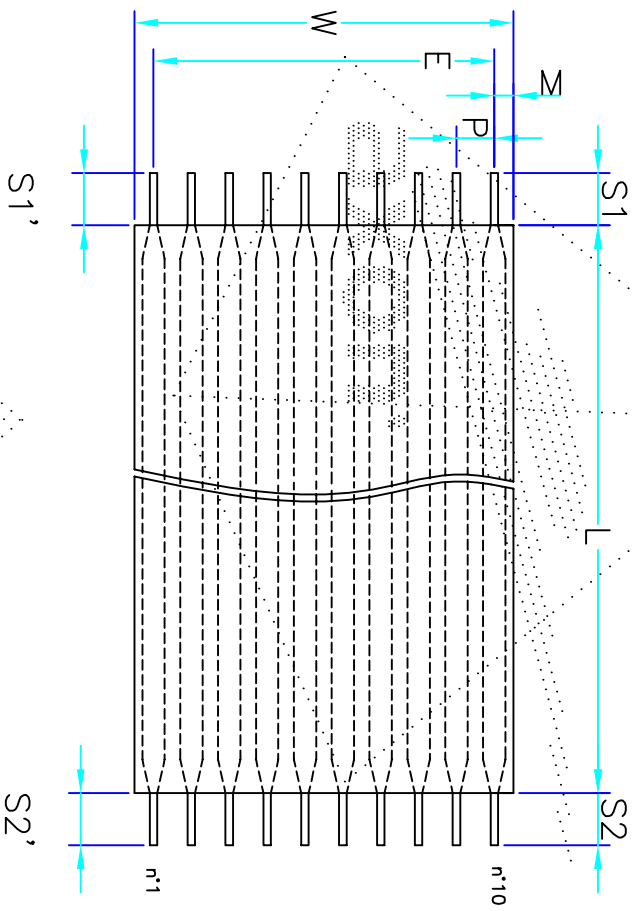
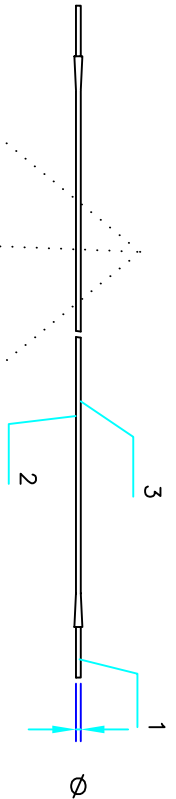

COMPOSITION:

COMPONENTS	UNITS	SPECIFICATIONS	Item
Conductor	Material	Tin plated copper (1,5 µm typ)	1
	Dimensions	AWG 24 - 1,50X0,12 for flat part	
Insulation	Material	Polyester+flame retardant adhesive	2 3
	Thickness	0,100 mm nominal	

CHARACTERISTICS

ITEMS	VALUE	TEST METHOD
Resistance of conductor	110 Ohm/km maxi	-
Conductor to conductor insulation resistance	10 MOhm.m mini	200 V DC
Dielectric test (conductor to conductor)	1 minute	500 V AC
Temperature rating	105 °C	-
Voltage rating	300 VDC maxi	-
Current rating	3,0 A maxi	-
Flame resistance	VW - 1	UL 758

PRELIMINARY DRAWING

DIMENSIONS

ITEMS	UNITS	SPECIFICATIONS
Number of conductors	-	10
Pitch	MM	2,54 ± 0,15
Span	MM	22,86 ± 0,20
Total width	MM	25,40 ± 0,15
Margin	MM	1,27 ± 0,20
Strip length	MM	3,00 ± 1,00
Strip length	MM	3,00 ± 1,00
Insulated length	MM	051,00 ± 3,00
Strip difference S-S'	MM	0,40 max

UNLESS OTHERWISE SPECIFIED:
DIMENSIONS : MM ANGLES : d.

FILE N° SJ11117A.dwg

CUSTOMER N° INELTRO

TITLE: RFC2,54C10/0051H3,0-3,0-00,0-00,0SA--

AXON'CABLE SA
51210 MONTMIRAIL - FRANCE
TEL : +33 3 26 81 70 00
FAX : +33 3 26 81 28 83
www.axon-cable.com

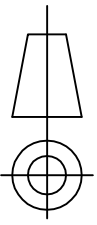

SIZE	AXON'SA N°	REV
A4	SJ11117	A
SCALE : N.D.		Doc.

This drawing is the property of Axon', and is issued on the condition that it is not copied or disclosed to any third party without prior written consent from Axon'Cable